



# COL 600V Metering CT

## Applications

600V metering current transformers are used in a variety of commercial metering applications where revenue class metering is necessary for billing purposes. The COL is specifically designed for higher amperage ratings with an 5.5" opening to handle primary cables.

## High Accuracy, Extended Range

High accuracy, extended range current transformers exceed the IEEE 0.15S accuracy standard. These CTs meet or exceed every 600V metering class CT in the industry with an accuracy of 0.15% from 1% of nominal current through rating factor. The COL is also available in standard accuracy.

## Construction

The core is constructed from wound layers of high accuracy, low loss electrical grade steel. The core is evenly wound with enamel coated copper wire to ensure against potential short circuits. The core and coil assembly is encapsulated in polyurethane specifically engineered for premium dielectric, mechanical and thermal properties for indoor and outdoor applications.

## Test Reports

Each COL has a unique serial number which allows the customer to track each test record. Certified test reports are stored electronically and provided with every shipment.

## Specifications

**Insulation:** 600V, 10kV BIL

**Frequency:** 60 Hz

**Environment:** Indoor/outdoor

**Standards:** IEEE C57.13-2016

**RUS:** The COL is RUS Listed

## Cross Reference

ABB CLC-S, Artech IRH-10, GE JAD-0S, GEC Durham Type AD, Ritz DCEW/DCEB



## AccuGrid™ Easy

- Ready to ship within 24 hours
- The industry's only 10-year warranty on instrument transformers
- Highest rating factors, temperature performance, and accuracies
- The broadest portfolio to match or replace any legacy brand
- Solid dielectric construction for extended outdoor life

Last revised: January 12, 2026

Photo by Fré Sonneveld on Unsplash

# Dimensions

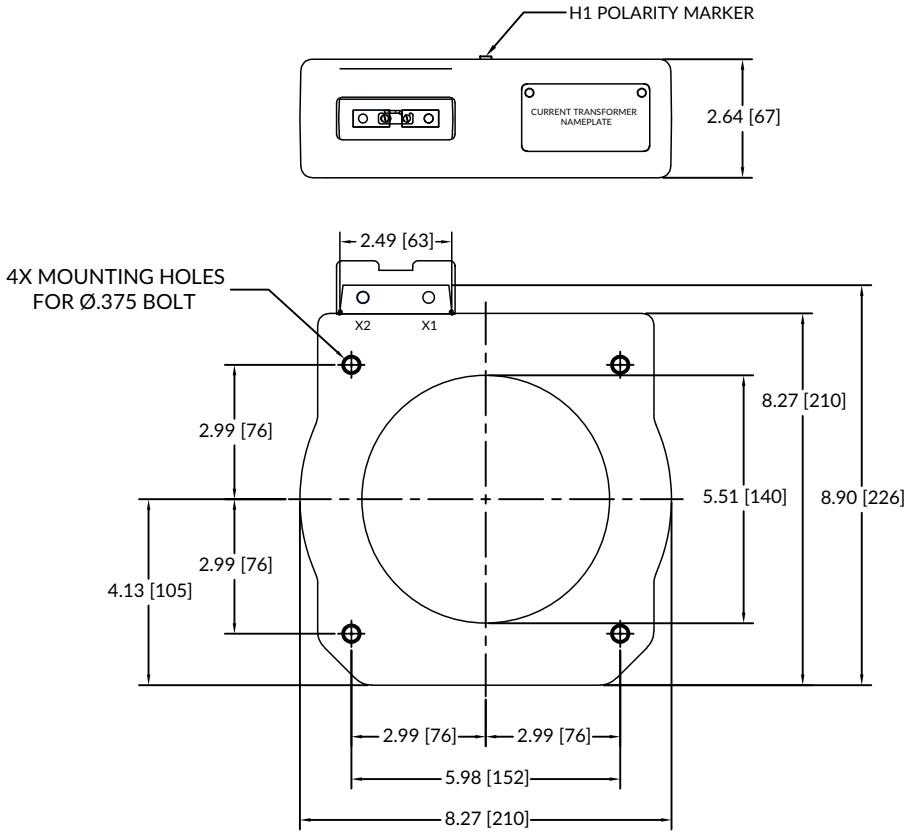

## Bar Max Amps

1950A, 1 Bar  
 3200A, 2 Bar  
 4200A, 3 Bar  
 5100A, 4 Bar

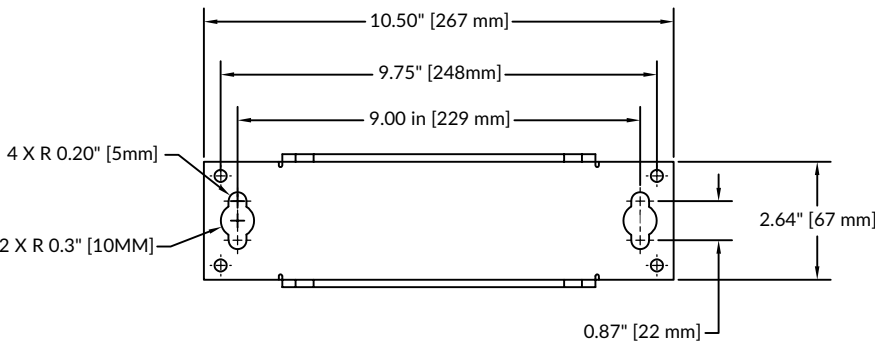
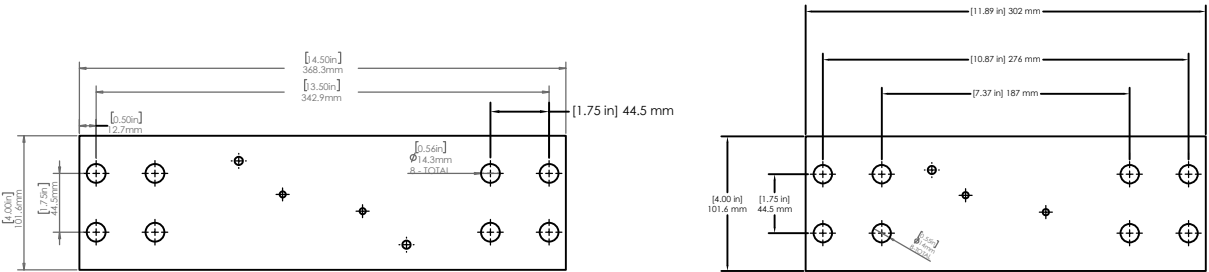

## Selection Guide

Product Number	Rated Current (A)	IEEE Metering Accuracy	Rating Factor	
High Accuracy	Ratio		30° C	55° C
COL1200ANN	1200:5	0.15SB-0.9	2.0	1.5
COL1500ANN	1500:5	0.15SB-0.9	3.0	2.5
COL2000ANN	2000:5	0.15SB-0.9	2.5	1.75
Standard Accuracy	Ratio		30° C	55° C
COL0600SNN	600:5	0.3B-0.5	3.0	2.2
COL0800SNN	800:5	0.3B-0.5	2.0	1.5
COL1000SNN	1000:5	0.3B-0.5	2.0	1.5
COL1200SNN	1200:5	0.3B-0.9	2.0	1.5
COL1500SNN	1500:5	0.3B-0.9	2.0	1.5
COL2000SNN	2000:5	0.3B-1.8	2.0	1.5
COL3000SNN	3000:5	0.3B-0.9	1.5	1.2
COL4000SNN	4000:5	0.3B-1.8	1.33	1.0

## Other ratios available upon request

## Key to Selection Guide

COL 2000 X X X

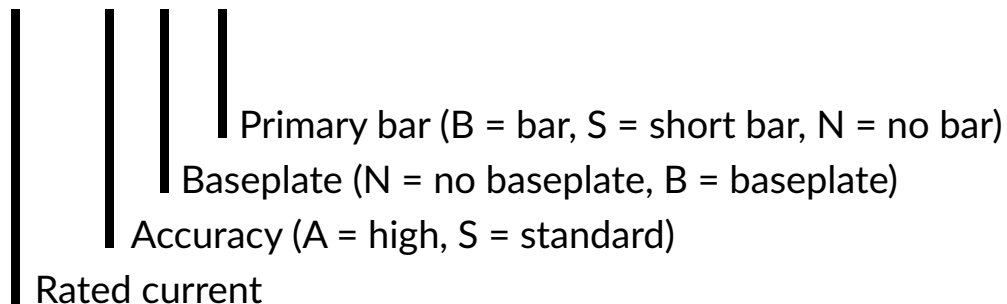

## Notes

High accuracy extended range units exceed the 0.15S class.  
Accurate from 1% of rated current to rating factor.

AccuGrid Technologies, Inc. strives to keep the information in this document current and accurate. Please contact us if there is any question as to the accuracy or completeness of the information contained in this document. Proper product selection and product application is the sole responsibility of the purchaser. AccuGrid reserves the right to discontinue any product or service at any time.

© AccuGrid Technologies, Inc. All rights reserved.